

HILTON AUSTIN CONVENTION CENTER HOTEL
SIXTH FLOOR

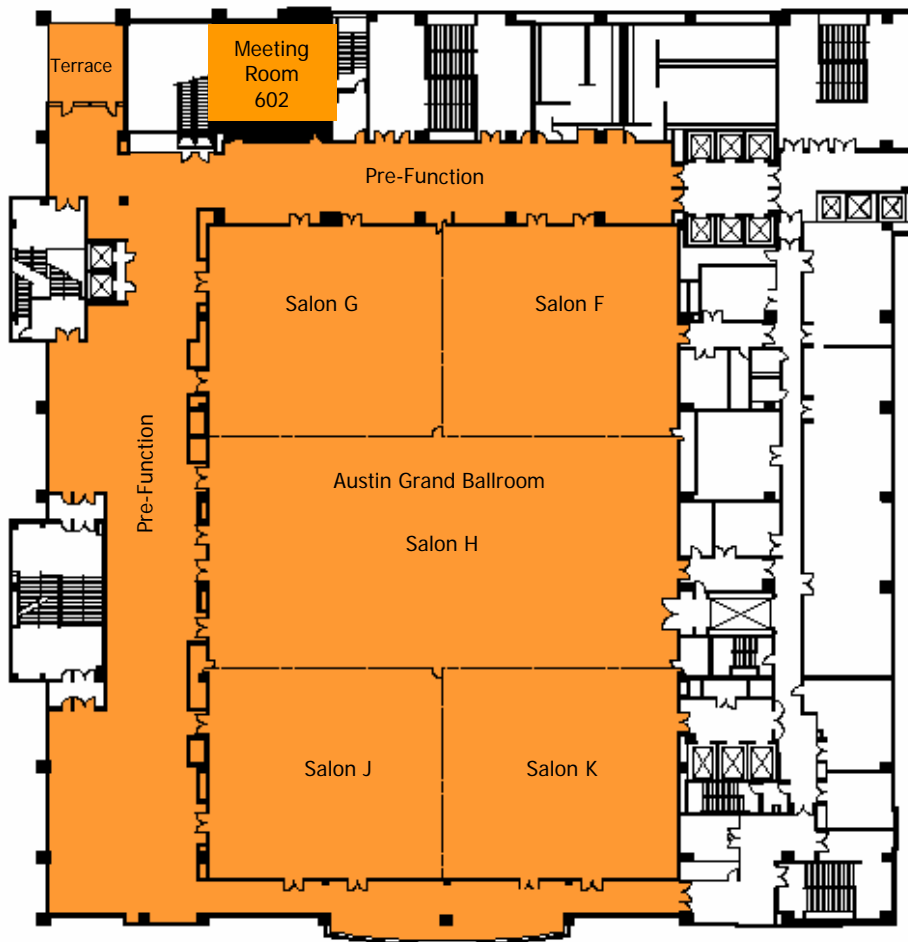

HILTON AUSTIN CONVENTION CENTER HOTEL
FOURTH FLOOR

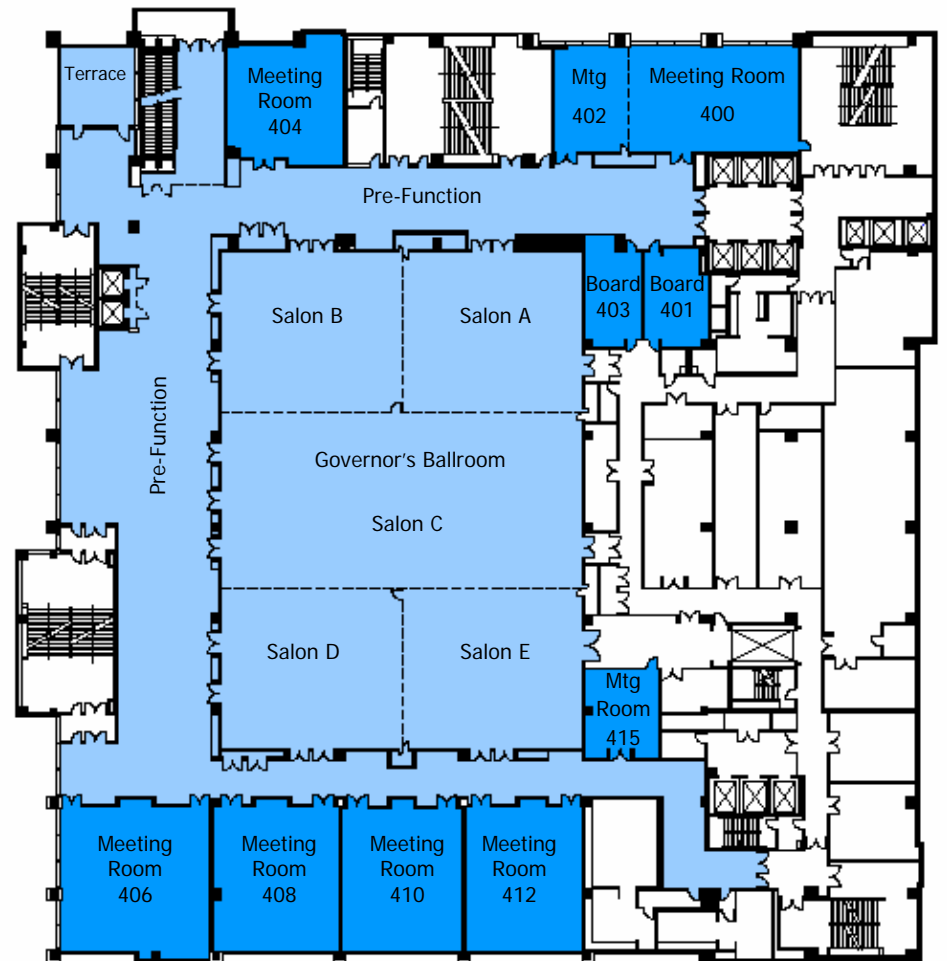

Hilton Austin Meeting Space Breakdown and Dimensions

Room Name	Dimension	Ceiling Height	Square Footage					Hollow			Exhibit	Exhibit	
				Classroom	Classroom	Theatre	Conference	Square	U-Shape	Banquet	Reception	8x10 Booths	10x10 Booths
SIXTH FLOOR				3 / table	2 / table								
Austin Grand Ballroom	140'-6.5" x 195'-4"	21'	27,452	1,620	1,080	3,000	N/A	N/A	N/A	1,900	3,000	183	138
Pre-Function	243' x 49'	21'	9,165	N/A	N/A	N/A	N/A	N/A	N/A	N/A	1,000	25	19
Salon F	63'-6" x 70'-3.25"	21'	4,462	264	176	540	80	80	75	300	540	30	24
Salon G	63'-6" x 70'-3.25"	21'	4,462	264	176	540	80	80	75	300	540	30	24
Salon H	68'-4" x 140'-6.5"	21'	9,603	552	368	1,216	N/A	N/A	N/A	660	1,216	51	50
Salon J	63'-6" x 70'-3.25"	21'	4,462	264	176	540	80	80	75	300	540	30	24
Salon K	63'-6" x 70'-3.25"	21'	4,462	264	176	540	80	80	75	300	540	30	24
Salon F - G	63'-6" x 140'-6.5"	21'	8,924	528	352	1,080	N/A	N/A	N/A	600	1,080	54	44
Salon F - H	131'-10" x 140'-6.5"	21'	18,528	1,080	720	2,296	N/A	N/A	N/A	1,260	2,296	115	93
Salon H - K	131'-10" x 140'-6.5"	21'	18,528	1,080	720	2,296	N/A	N/A	N/A	1,260	2,296	115	92
Salon J - K	63'-6" x 140'-6.5"	21'	8,924	528	557	1,064	N/A	N/A	N/A	600	1,080	55	44
Meeting Room 602	29'-10" x 33'-1.5"	12'-1"	1,133	60	40	127	24	30	22	60	127	N/A	N/A
FOURTH FLOOR													
Governor's Ballroom	106'-8" x 146'-4"	15' 10"	15,608	1,000	674	1,980	N/A	N/A	N/A	1,076	1,961	101	86
Pre-Function	197' x 49'	15' 10"	6,421	N/A	N/A	N/A	N/A	N/A	N/A	N/A	750	15	10
Salon A	47'-4" x 53'-4"	15' 10"	2,524	144	96	300	N/A	60	50	160	300	16	16
Salon B	47'-4" x 53'-4"	15' 10"	2,524	144	96	300	N/A	60	50	160	300	16	16
Salon C	51'-8" x 106'-8"	15' 10"	5,511	306	204	756	N/A	N/A	N/A	360	756	38	28
Salon D	47'-4" x 53'-4"	15' 10"	2,524	144	96	300	N/A	60	50	160	300	16	16
Salon E	47'-4" x 53'-4"	15' 10"	2,524	144	96	300	N/A	60	50	160	300	16	16
Salon A - B	47'-4" x 106'-8"	15' 10"	5,048	288	192	600	N/A	N/A	N/A	320	600	33	24
Salon A - C	99'-0" x 106'-8"	15' 10"	10,559	594	396	1,356	N/A	N/A	N/A	680	1,356	68	48
Salon C - E	99'-0" x 106'-8"	15' 10"	10,560	594	396	1,356	N/A	N/A	N/A	680	1,356	68	48
Salon D - E	47'-4" x 106'-8"	15' 10"	5,048	288	192	600	N/A	N/A	N/A	360	600	33	24
Meeting Room 400 & 402	30'-11" x 71'-10"	12'-4"	2,220	132	96	269	54	54	48	120	269	N/A	N/A
Meeting Room 400	30'-11" x 50'-1.5"	12'-4"	1,549	96	64	195	42	54	48	80	195	N/A	N/A
Meeting Room 402	21'-8" x 30'-11"	12'-4"	671	45	30	87	24	32	24	50	87	N/A	N/A
Meeting Room 404	32'-7" x 34'-5"	12'-4"	1,159	60	40	153	24	36	33	60	153	N/A	N/A
Meeting Room 406	44'-4" x 42'-1.5"	17'-10"	1,926	126	84	264	42	60	45	120	264	N/A	N/A
Meeting Room 408	37'-2" x 42'-1.5"	17'-10"	1,581	102	68	197	30	48	39	90	197	N/A	N/A
Meeting Room 410	35'-9" x 42'-1.5"	17'-10"	1,530	84	56	209	30	48	39	90	209	N/A	N/A
Meeting Room 412	34'-8" x 42'-1.5"	17'-10"	1,485	84	56	198	30	48	39	90	198	N/A	N/A
Meeting Room 415	21'-4.5" x 23'-9"	12'-0"	500	24	16	58	18	18	18	30	58	N/A	N/A
Board Room 401	16'-11" x 25'-8"	12'-0"	473	N/A	N/A	N/A	14	N/A	N/A	N/A	N/A	N/A	N/A
Board Room 403	18'-3" x 25'-8"	12'-0"	458	24	16	56	18	18	24	20	56	N/A	N/A

Total Number of Room Configurations: 32
Total Square Footage: 71,111 (includes Prefunction Space)